

JACKODUR® Atlas

Perfect floor slab insulation for every type of house.

Complete solution

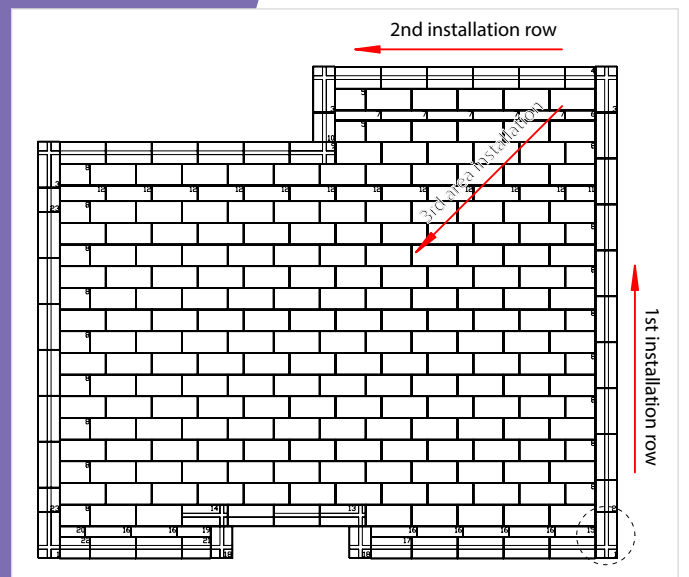
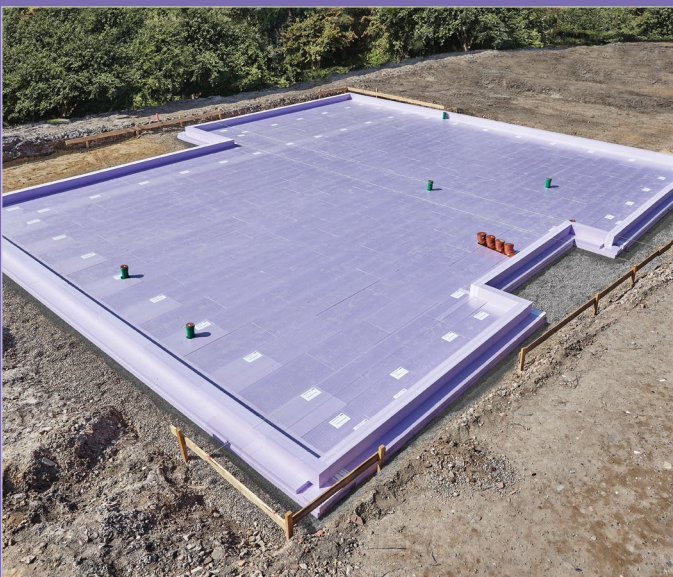

Installation Instructions

JACKON
by BEW

JACKODUR® Atlas – Complete system

General notes

With JACKODUR® Atlas, you have chosen a time and money-saving floor slab insulation system suitable for different layouts. JACKODUR® Atlas comprises various elements which can be combined individually.

The innovative plug-in system systematically excludes thermal bridges and the insulation meets all current energy standards. The JACKODUR® Atlas system is made of extruded polystyrene foam (XPS) according to EN 13164.

JACKODUR® Atlas elements:

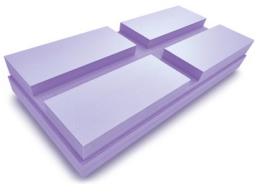

Corner element

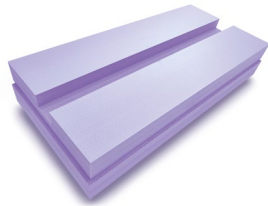

Side element



Area element

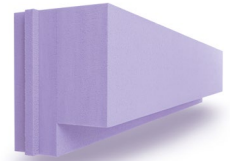

Formwork element

You receive an installation plan that shows where the tailor-made insulation elements (special elements) have to be positioned

The packing list provided shows you which pallet contains the special elements.

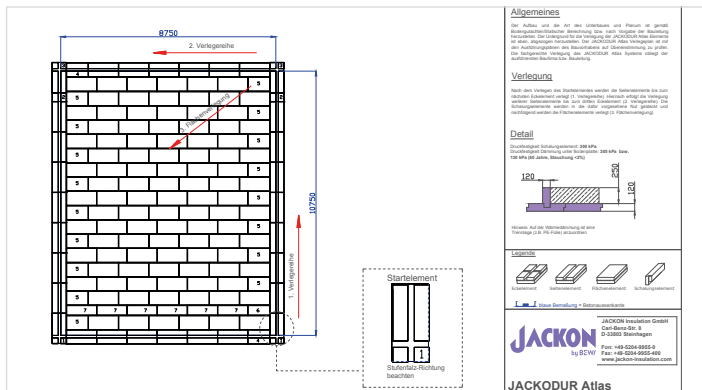

JACKODUR® Atlas	
Objekt: D_3369	
Auftragsnummer: A400245592	
Packliste:	
PaLETTE 01	48 Stck. Flächenelement
PaLETTE 02	48 Stck. Flächenelement
PaLETTE 03	48 Stck. Flächenelement
PaLETTE 04 (48)	35 Stck. Flächenelement 13 Stck. Seitenelement
PaLETTE 05 (48)	20 Stck. Seitenelement 4 Stck. Sonderelement Nr.3 1 Stck. Sonderelement Nr.30 4 Stck. Sonderelement Nr.1 1 Stck. Sonderelement Nr.21 1 Stck. Sonderelement Nr.32 9 Stck. Sonderelement Nr.9 1 Stck. Sonderelement Nr.8 1 Stck. Sonderelement Nr.36 1 Stck. Sonderelement Nr.14 1 Stck. Sonderelement Nr.31 1 Stck. Sonderelement Nr.16

1. Preparation of the site and setting out.

It is fundamental to avoid any risk of frost below the foundation. That is why the hardcore has to comply with the requirements of the planner/structural engineer. Typically the hardcore is made of crushed stone, granular and is non-frost susceptible (good draining). If the hardcore is frost susceptible or if the maximal local depth of frost penetration is not reached then a frost insulation (ISO13793) has to be installed. Crushed stone 2/5 or 4/8 is an ideal material for a leveling filler layer on the top of hardcore. For the substrate, a tolerance of +/- 1 cm over 5 m is recommended for a precision fit insulation arrangement. The blinding layer should be applied about 40 cm wider than the outer edge of the floor slab. If possible, the batter board should be erected at a distance of about 80 cm from the outer edge of the floor slab. For further preparation, the layout lines are stretched over the outer edge of the floor slab (without thermal insulation).

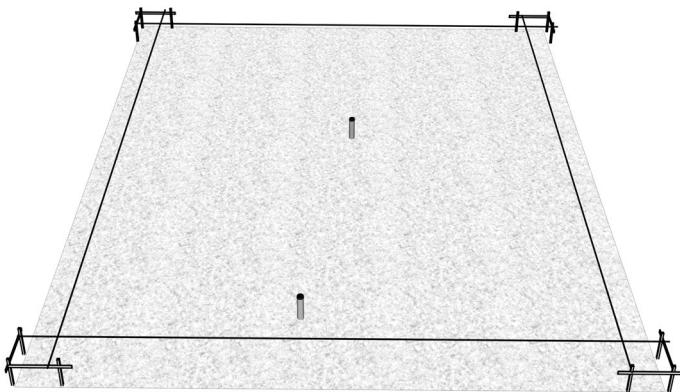

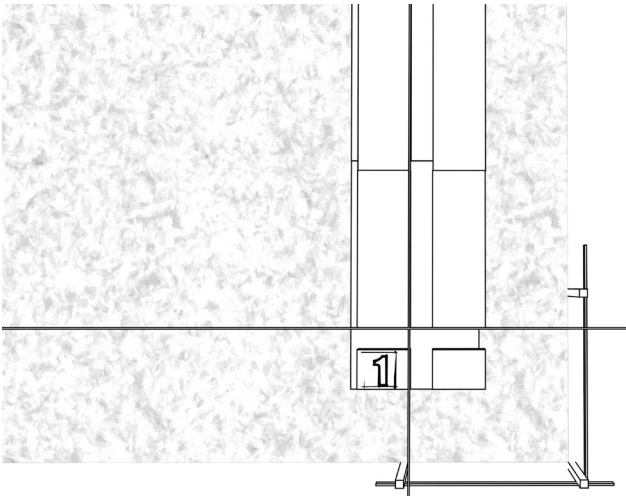

2. Begin with the initial element

The installation plan shows which corner to begin the installation. The initial element must be installed as shown in the plan (note direction of stepped profile!). With the aid of the erected batter board arrangement, use the tensioned layout line to arrange the initial element (outer edge of the floor slab). Then install the side elements in the direction "1st installation row" and thereafter continue the installation in the direction "2nd installation row" until the edge is complete.

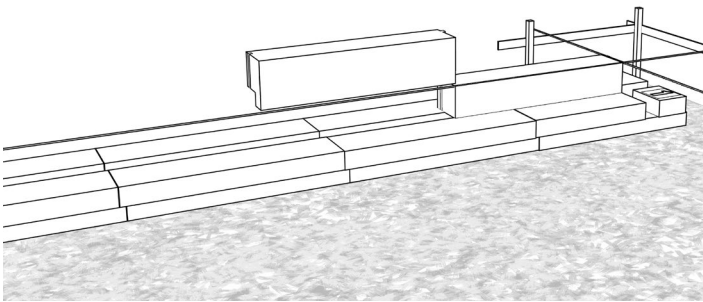

3. Formwork elements

Subsequently, insert the formwork elements progressively into the groove of the side elements with joints offset till the next corner element is reached. The formwork elements must be cut to length (e.g. with a handsaw or a hot wire cutter).

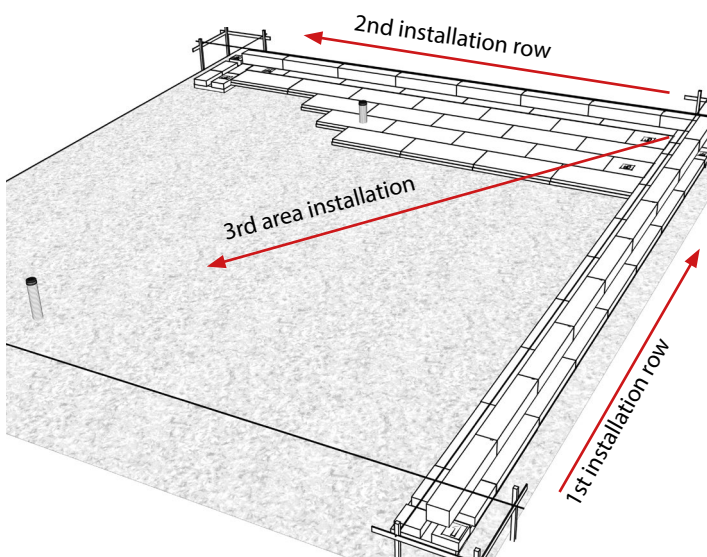
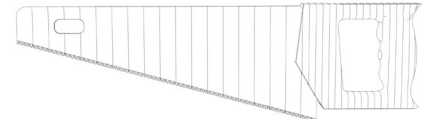

4. Area elements

Install the area elements according to the installation plan in the direction "3rd area installation".

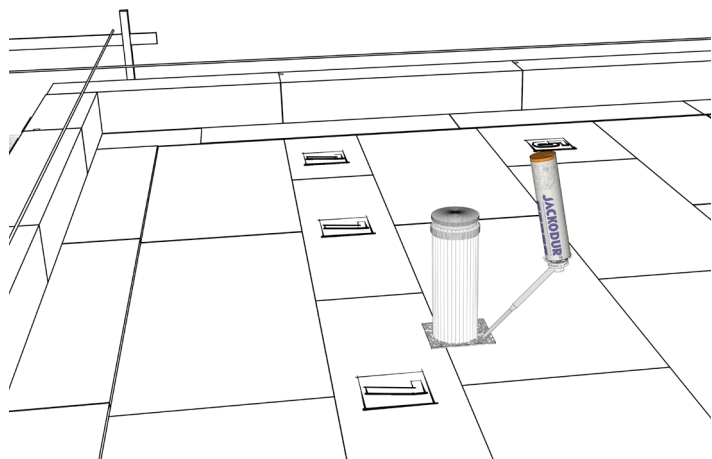

5. Penetrations (e.g. for drainage lines, conduits, ventilation ducts) must be notched to size on site, e.g. with a handsaw or portable jigsaw. Use JACKODUR® Perimeter Adhesive (λ 0.0354) to seal off penetrations and open joints in the insulation layer.

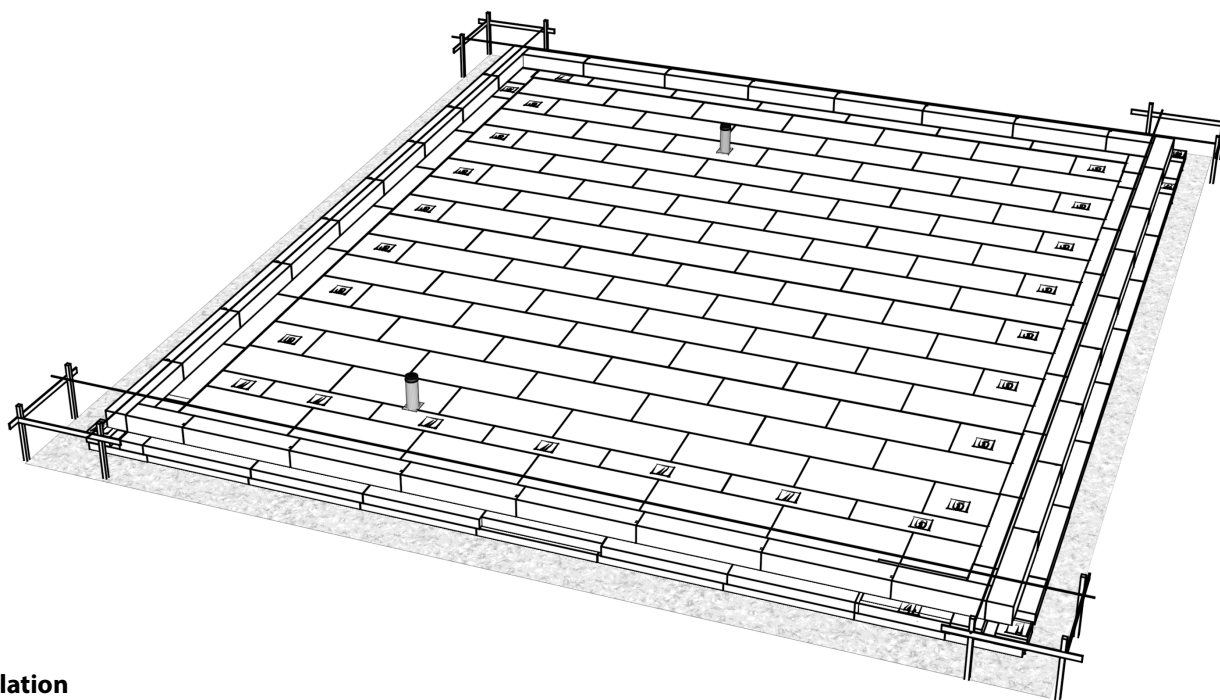
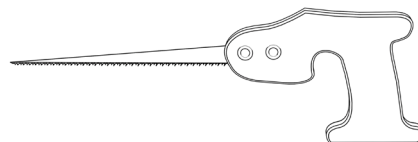

6. After installation

Subsequently, install a separation layer, e.g. PE film, over the thermal insulation boards. Install it loose and with overlapping, taped joints.



Application film
JACKODUR® Atlas

Note

The information in this publication represents our current state of knowledge and experience. They do not represent any guarantee in the legal sense of the term. When using these products, the specific conditions relative to the particular application must always be taken into account, especially with regard to structural physics, civil engineering and statutory building regulations.

JACKON Insulation GmbH

Carl-Benz-Straße 8
D-33803 Steinhagen

T +49 (0) 5204 9955 - 499
F +49 (0) 5204 9955 - 400

E atlas@jackodur.com
W www.jackon-insulation.com

JACKON
by BEW